

Drain & Breather for Hazardous and Non-Hazardous Locations

KILLARK®

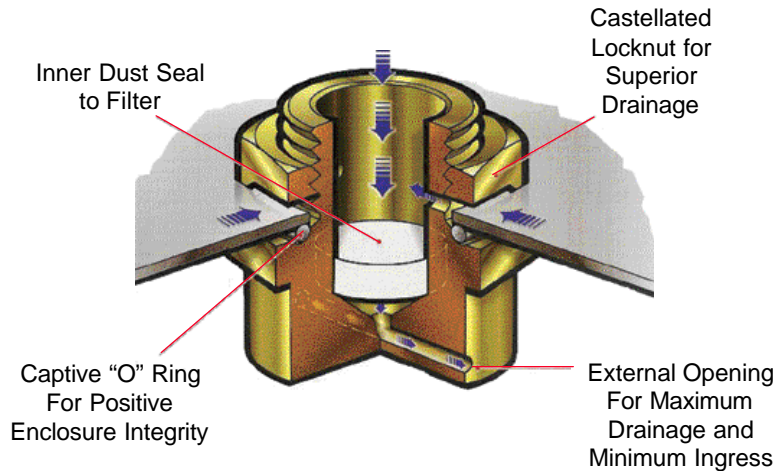

CLASSIFICATIONS:

Class I, Division 2, Groups A, B, C & D
 Class I, Zone 1, Ex e IIC Groups IIC, IIB, & IIA
 Class I, Zone 1, AEx e IIC Groups IIC, IIB, & IIA
 Class II, Groups E, F & G
 NEMA, CSA Type 3, 4, 4(X)
 IP 66

APPLICATIONS

The Redapt Series Drain and Breather accommodates atmospheric pressure changes by allowing an enclosure to "breathe" and effectively allows moisture or condensation to drain from an enclosure.

This unique design maintains the water-resistant rating of the enclosure (i.e. CSA Type 4(X), IP66). A captive "O" ring is used to seal against an enclosure to maintain its original rating.

To allow liquid to drain before it builds up to the top of the drain, a specially designed locknut is used. This allows moisture to seep out under the locknut above the "O" ring for maximum drainage.

An inner dust seal prevents contaminants from entering an enclosure. This non-stick material allows for easy cleaning of any internal debris that may build up.

The Redapt Series Drain and Breather is available in aluminum, brass, mild steel, type 316 stainless steel and fibre reinforced nylon.

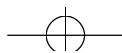

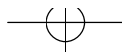

FEATURES

- CSA Type 3, 4, 4X Rated Protection For Hosedown And Corrosion Protection
- (A) Ex e Increased Safety Design
- Captive Premium "O" Ring for Enclosure Integrity
- Castellated Locknut For Maximum Drainage
- Wide Choice Of Materials
- Global Certification CSA/NRTL/US CENELEC/ATEX

ORDERING INFORMATION

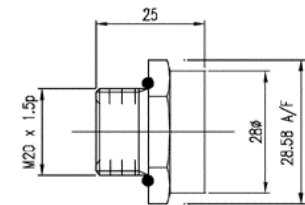

M20

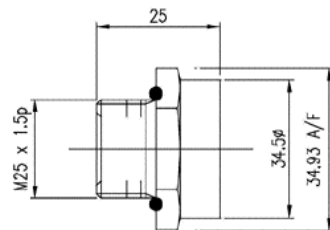

M25

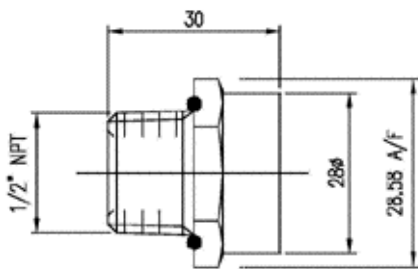

1/2" NPT

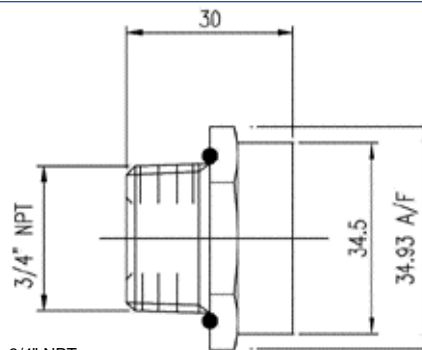

3/4" NPT

Size	30% Glass Filled Nylon	Brass	Nickel Plated Brass	Mild Steel	316 Stainless Steel	Aluminum
M20	DPE-40-04-S3	DPE-10-04-S1	DPE-11-04-S1	DPE-20-04-S1	DPE-30-04-S1	DPE-50-04-S1
M25	DPE-40-05-S3	DPE-10-05-S1	DPE-11-05-S1	DPE-20-05-S1	DPE-30-05-S1	DPE-50-05-S1
1/2" NPT	DPE-40-04-S3	DPE-10-29-S3	DPE-11-29-S3	DPE-20-29-S3	DPE-30-29-S3	DPE-50-29-S3
3/4" NPT	DPE-40-05-S3	DPE-10-30-S3	DPE-11-30-S3	DPE-20-30-S3	DPE-30-30-S3	DPE-50-30-S3

TECHNICAL DATA

Ingress Protection	Nema 4X (Hosedown, Corrosion Resistant), IP66
Impact Resistance	20Nm (7Nm GF Nylon and Aluminum)
Ambient Temperature	-50 to +85C -58 to +185F
Materials	30% GF Nylon, Brass, 316 Stainless Steel, Aluminum, Mild Steel
Plating	Nickel, Zinc, Cadmium, Chromatise, Electroless Nickel
"O" Ring	Nitrile Rubber
Dust Seal	Polyethylene, Polypropylene and Polyvinylidene Flouride

Redapt Series Drain and Breather can be used in either threaded entries or clearance hole applications. Custom thread types and sizes are available upon request.



Wiring Device-Kellems
 Hubbell Canada Inc.
 870 Brock Road South, Pickering, ON L1W 1Z8 • (905) 839-1138 • Fax: (905) 839-9108
 www.hubbell-canada.com
 TECHNICAL SERVICES: 1-877-233-8324

Worldwide Locations

Hubbell Incorporated (Delaware) (203) 882-4800, Fax (800) 255-1031
 Hubbell Ltd. England (441) 234-855444, Fax (441) 234-854008
 Hubbell-Taian Co., Ltd., (886) 2 567-5995, Fax (886) 2 567-4853

Hubbell de Mexico, S.A. de C.V. (52) 5 575-2022, Fax (52) 5 559-8626
 Caribe Sales Agencies, Puerto Rico (809) 720-7185, Fax (809) 789-2796

